

# EXPLODED VIEW (BQG 170 / BQG 170 M)

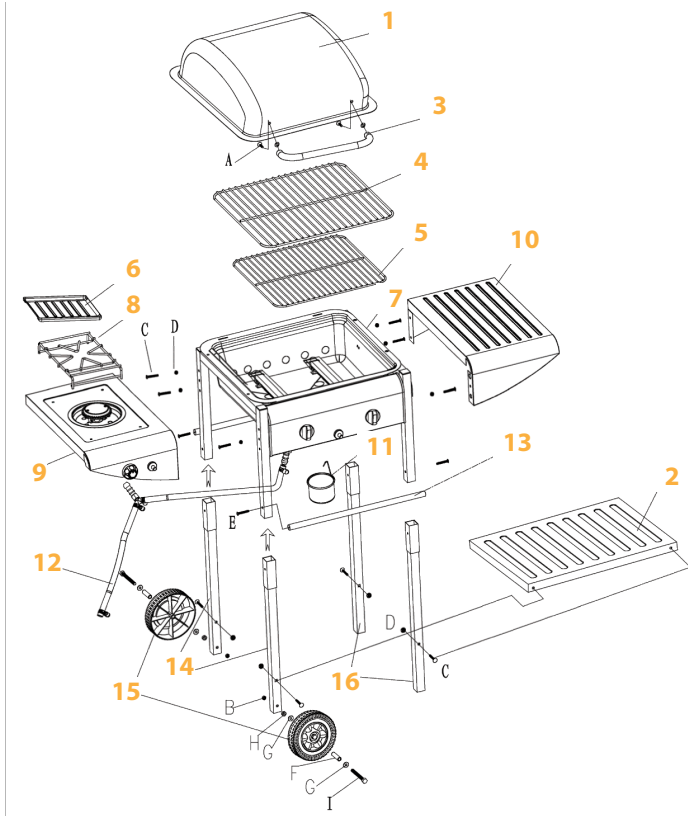

**A) M6\*12**

**2 PCS**



**B) M6**

**2 PCS**



**C) M5\*35**

**12 PCS**



**D) M5**

**12 PCS**



**E) M4\*40**

**4 PCS**



**F)**

**2 PCS**



**G)**

**4 PCS**



**H)**

**2 PCS**



**I) M6\*75 2 PCS**

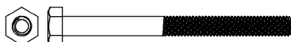

**J)**

**2 PCS**



## EXPLODED VIEW (BQG 170 W)

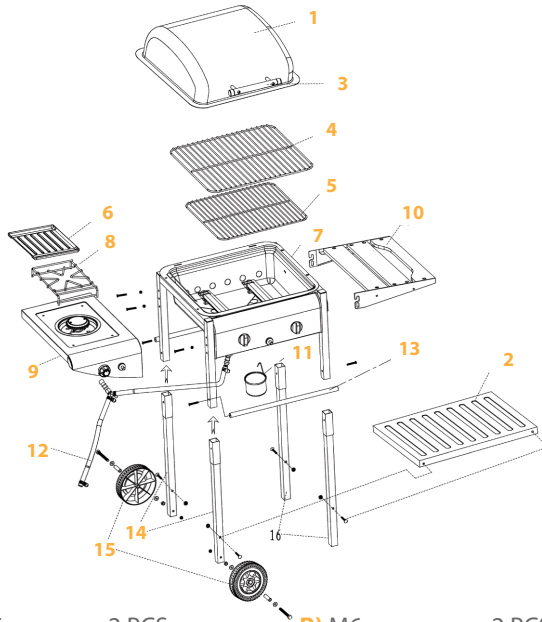

**A)** M6\*6

2 PCS

**B)** M6

2 PCS

**C)** M5\*40

2 PCS

**D)** M5

10 PCS

**E)** M4\*40

4 PCS

**F)** M4\*40

4 PCS

**G)**  $\Phi$  6,5,

4 PCS

**H)**  $\Phi$  6,5,

4 PCS

**I)** M6\*75

2 PCS

**J)**

2 PCS

**K)** M6\*35

**L)** M6

**M)** 2 PCS



## FOR EASY ASSEMBLY

- a) To avoid losing any small components or hardware, assemble your product on a hard level surface that does not have cracks or openings.
- b) Clear an area large enough to layout all components and hardware.
- c) When applicable, tighten all hardware connections by hand first. Once the step is completed go back fully tighten all hardware.
- d) Follow all steps in order to properly assemble your product.

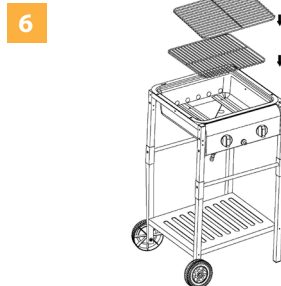
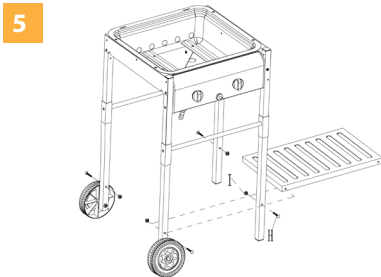
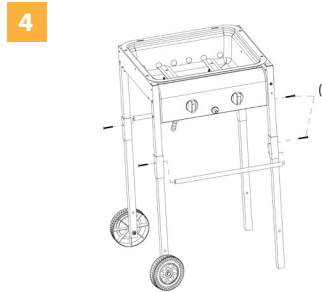
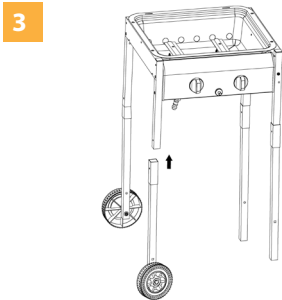
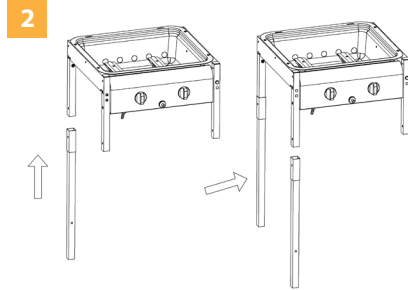
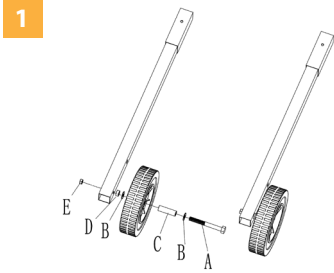

7

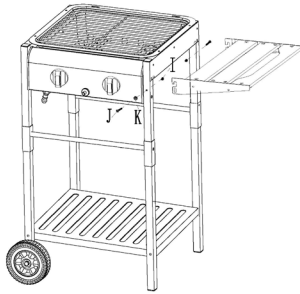

8

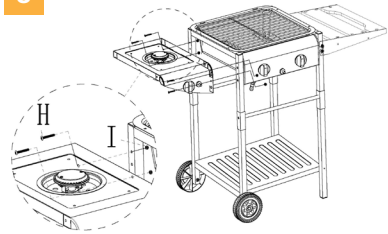

9

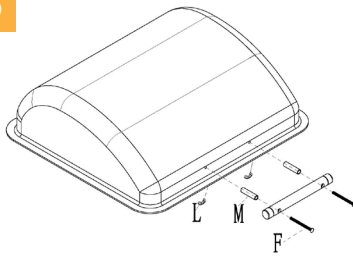

10

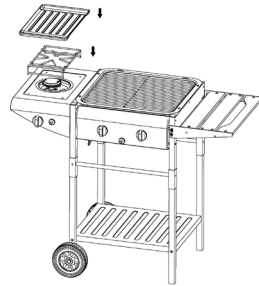

11

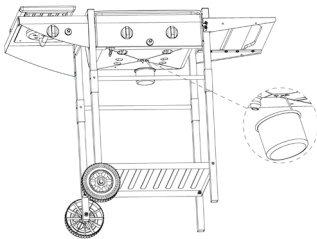

12

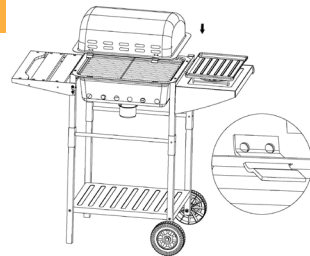

13



14



7

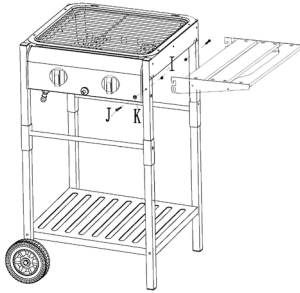

8

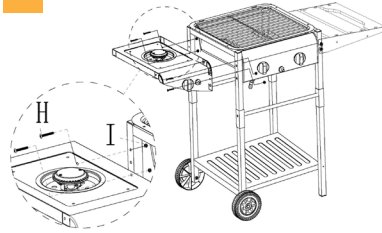

9

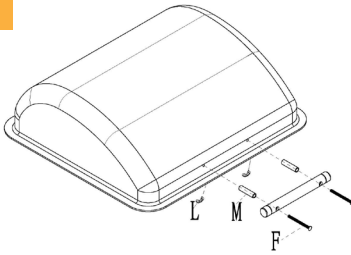

10

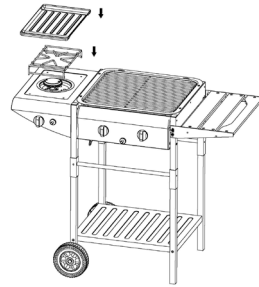

11

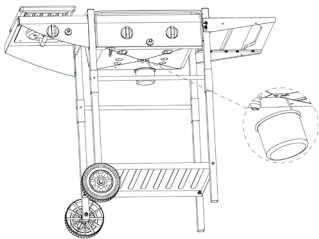

12

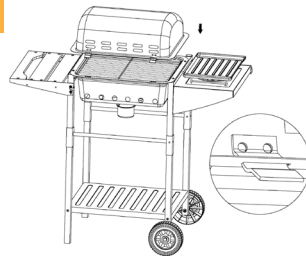

13



14



برای سرهم‌بندی آسان

- برای پیش‌گیری از گم‌شدن قطعات ریز دستگاه، آن را بر روی سطحی سخت و صاف و بدون ترک یا شکاف سرهم کنید.
- فضایی باز را برای چیدن تمامی قطعات و ابزارهای ویژه سرهم‌بندی در نظر بگیرید.
- پس از پایان سرهم‌بندی، ابتدا تمامی اتصالات را با دست محکم کنید. پس از این کار، یک بار دیگر محل اتصال قطعات را واریسی کرده و محکم کنید.
- برای سرهم‌بندی درست دستگاه مطابق روش توصیف شده عمل کنید.

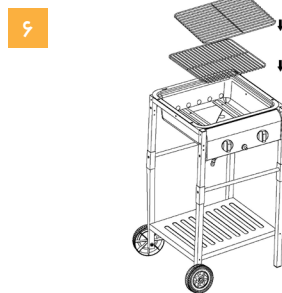
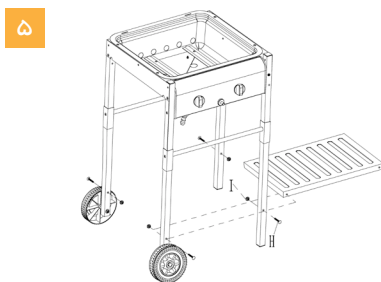
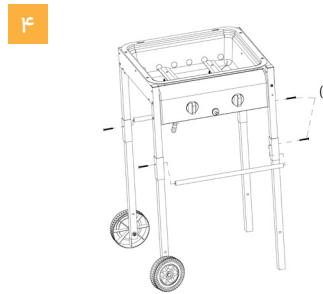
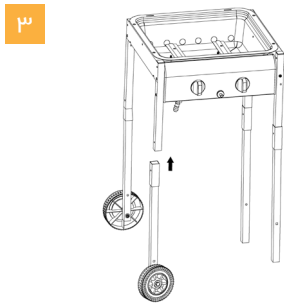
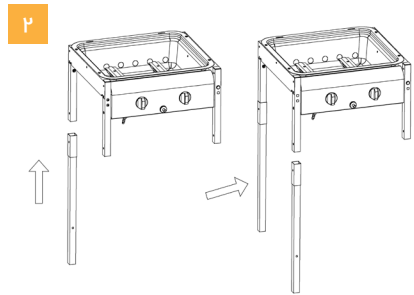
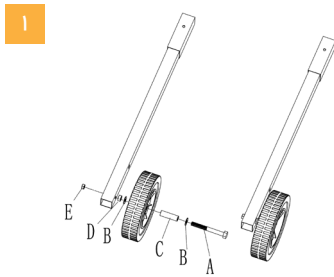

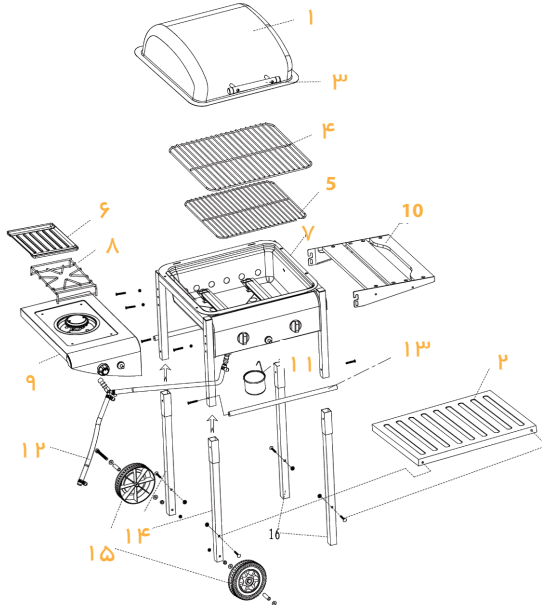

**A)** M6\*6

2 PCS

**B)** M6

2 PCS

**C)** M5\*40

2 PCS

**D)** M5

10 PCS

**E)** M4\*40

4 PCS

**F)** M4\*40

4 PCS

**G)**  $\Phi$  6.5,

4 PCS

**H)**  $\Phi$  6.5,

4 PCS

**I)** M6\*75

2 PCS

**J)**

2 PCS

**K)** M6\*35

**L)** M6

**M)** 2 PCS



توصيف اجزا (BQG 170/ BQG 170 M)

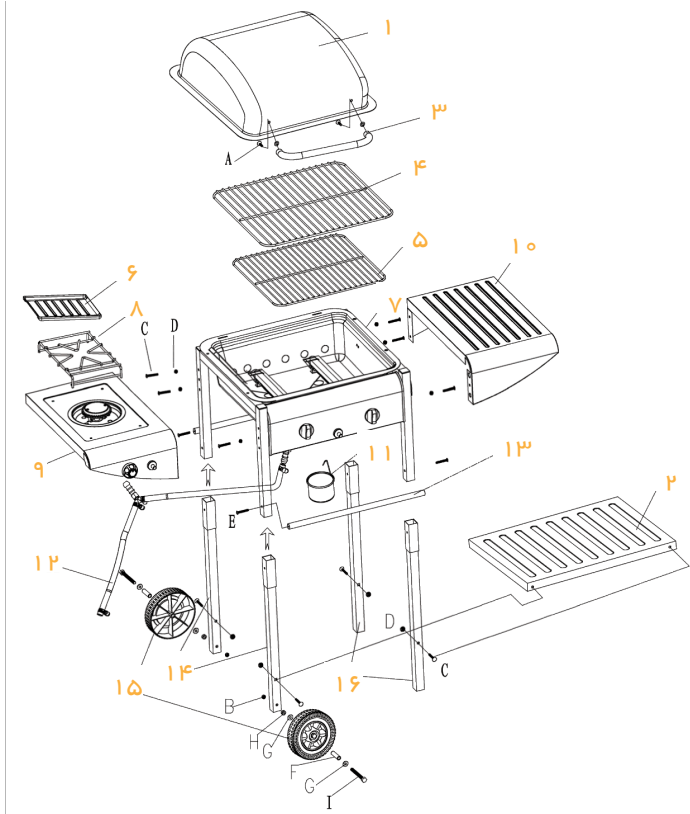

**A) M6\*12 2 PCS**

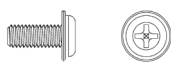

**B) M6 2 PCS**



**C) M5\*35 12 PCS**



**D) M5 12 PCS**



**E) M4\*40 4 PCS**



**F) 2 PCS**



**G) 4 PCS**



**H) 2 PCS**



**I) M6\*752 PCS**



**J) 2 PCS**

